



# Kestrel 5700 Elite

## App Quick Start Guide

# 1

Insert the **included batteries** in your Kestrel and then attach the lanyard (*included*).



Battery Door Latch

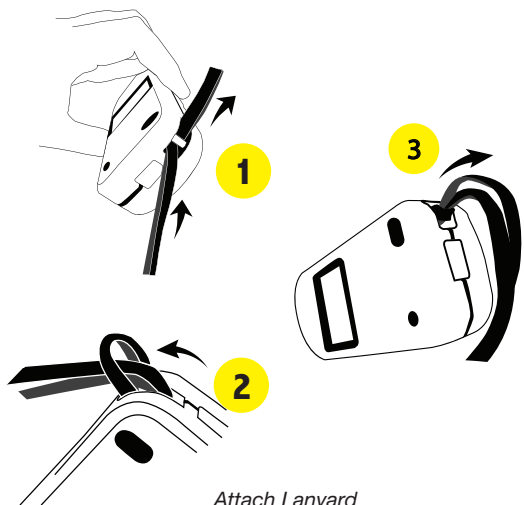

Attach Lanyard

**Note:** If using a non-LiNK unit, skip the remainder of this guide and visit [www.kestrelballistics.com/help](http://www.kestrelballistics.com/help) for a complete instruction manual.

# 2

Download **Kestrel LiNK Ballistics** app to your mobile device.

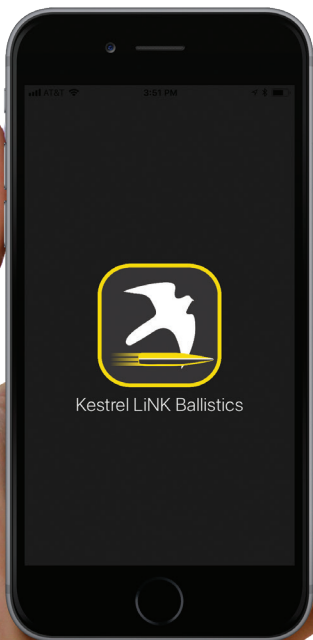

**Note:** Make sure to choose **LiNK Ballistics**, not **LiNK Weather**, when selecting the app.

# 3

Open the app and connect to your Kestrel.

**Note:** Bluetooth icon on single target and target card screens turns green (🟢) when Kestrel is paired to mobile device.

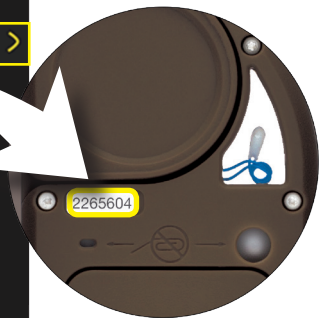
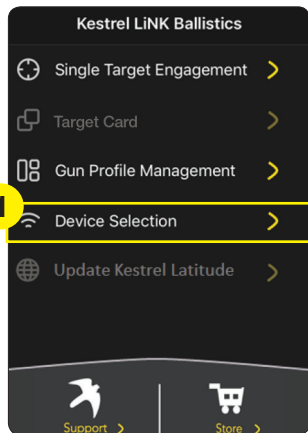

**Trouble Shooting:** Make sure Bluetooth is turned on in your mobile device. Make sure Bluetooth is turned on in your Kestrel and set Connect to PC/Mobile in the Bluetooth Sub Menu. Your Kestrel will not appear on the Bluetooth connection menu in your mobile device. Use the Device Selection button in the app to connect.

# 4

Press the button to update the latitude in your Kestrel.

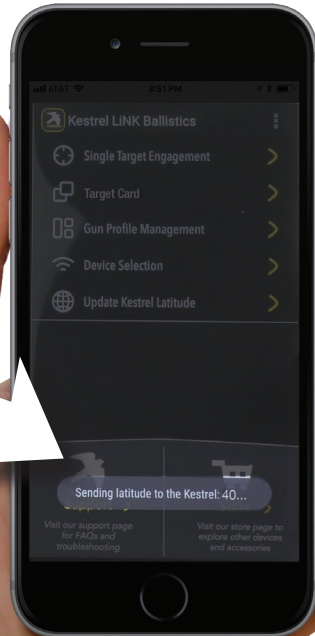
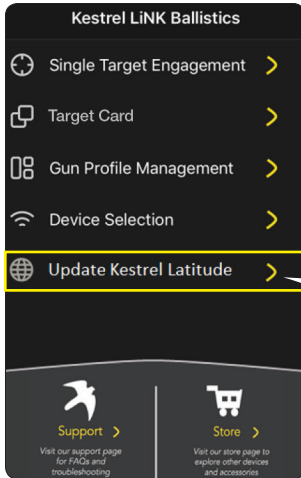

# 5

Input your gun & bullet information in the app then save it as a gun profile.

**Hint:** The Bullet Library contains the needed inputs for hundreds of common long range bullets. If you don't know one of the inputs for your gun, tap the parameter name for additional guidance

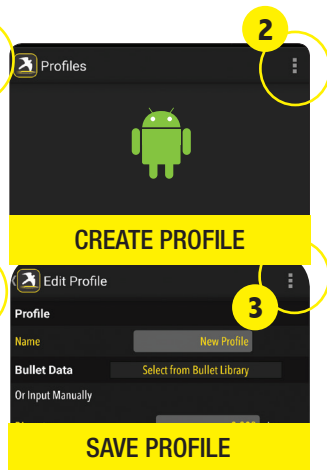
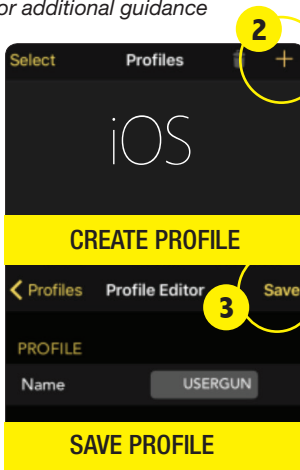
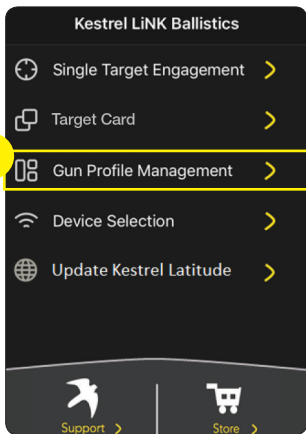

**Note:** On some android devices, use the  button.

**Note:** Building gun profiles in the app is the easiest method. Gun profiles can also be created directly in the Kestrel in Ballistics Mode.

# 6

Send your gun profile from the app to the Kestrel.

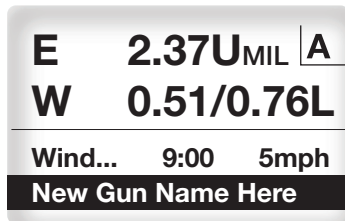
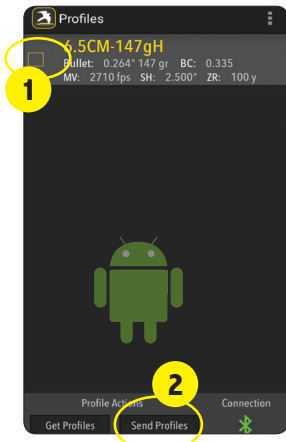

*In the Kestrel, scroll down to make sure the gun profile transferred correctly.*

**Note:** To edit gun info or to create a new gun profile, repeat steps 5 & 6

KESTREL BUTTONS

◀▼▶▲ Scroll/Toggle ← Select ⚙ Exit ⏻ On/Off

# 7

On startup, the Kestrel will open to the Solution Screen. Press the EXIT button to open the system menu and follow the screens below to start the Compass Calibration routine, then follow the on-screen instructions.

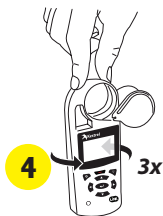
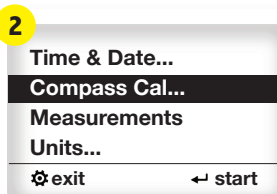
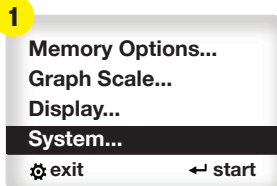

## Trouble Shooting:

If compass calibration is failing, try standing the Kestrel on a flat surface (non-metallic) while rotating. Make sure the Kestrel is in a vertical position before pressing start and remains vertical throughout the calibration turns.



# 8

At this point your Kestrel is ready for use. If you are new to using a Kestrel, we recommend starting with Easy Mode which provides a streamlined set of features for easier operation. To turn on Easy Mode, press the EXIT button to enter the setting menu and change the Mode from Ballistics to Easy. Once you are comfortable using Easy Mode, you can explore the additional features available in the full Ballistics Mode.



# 9

If using Easy Mode, on the Kestrel's solution screen, scroll to Target Setup and press select, then follow on screen instructions.

Repeat this step each time you shoot at a new target in a different direction or if the wind or temperature have changed.



KESTREL BUTTONS

◀▼▶▲ Scroll/Toggle   ← Select   ⚙ Exit   Ⓛ On/Off

# 10

If using Easy Mode, on the Kestrel's solution screen, scroll to Target Range and press left or right to dial to the correct target distance. Next dial the solution in your scope's turrets or hold-over using in your scope's reticle and shoot your target!

***Hint:** If unsure of your Muzzle Velocity, or if the solution provided by the Kestrel is not matching your point of aim, use the MV Cal Guide feature at the bottom of the Kestrel's Easy Mode menu to improve accuracy.*





By

NIELSEN-KELLERMAN

21 Creek Circle

Boothwyn, PA 19061

**Kestrel® Weather and Environmental  
Meters are designed and manufactured  
in the USA**

For additional help, support videos  
and a full manual visit

**[www.kestrelballistics.com/help](http://www.kestrelballistics.com/help)  
or contact us at (610) 447-1555**